

DISTRICT	COUNTY	ROUTE	SECTION	SHEET
6-0	MONTGOMERY	0152	LPS	12 OF 12
CHELTENHAM AND ABINGTON TOWNSHIPS				
REVISION NUMBER	REVISIONS	DATE	BY	

PCMS RECOMMENDED MESSAGES AS FOLLOWS OR AS DIRECTED:

WHEN	SCREEN 1	SCREEN 2	SCREEN 3
7 DAYS PRIOR TO IMPLEMENTING WEEKEND DETOUR	PA 152 TO BE CLOSED	AT EDGE HILL ROAD	<DATE>
DURING DETOUR	PA 152	CLOSED AT EDGE HILL ROAD	FOLLOW PA 152 DETOUR

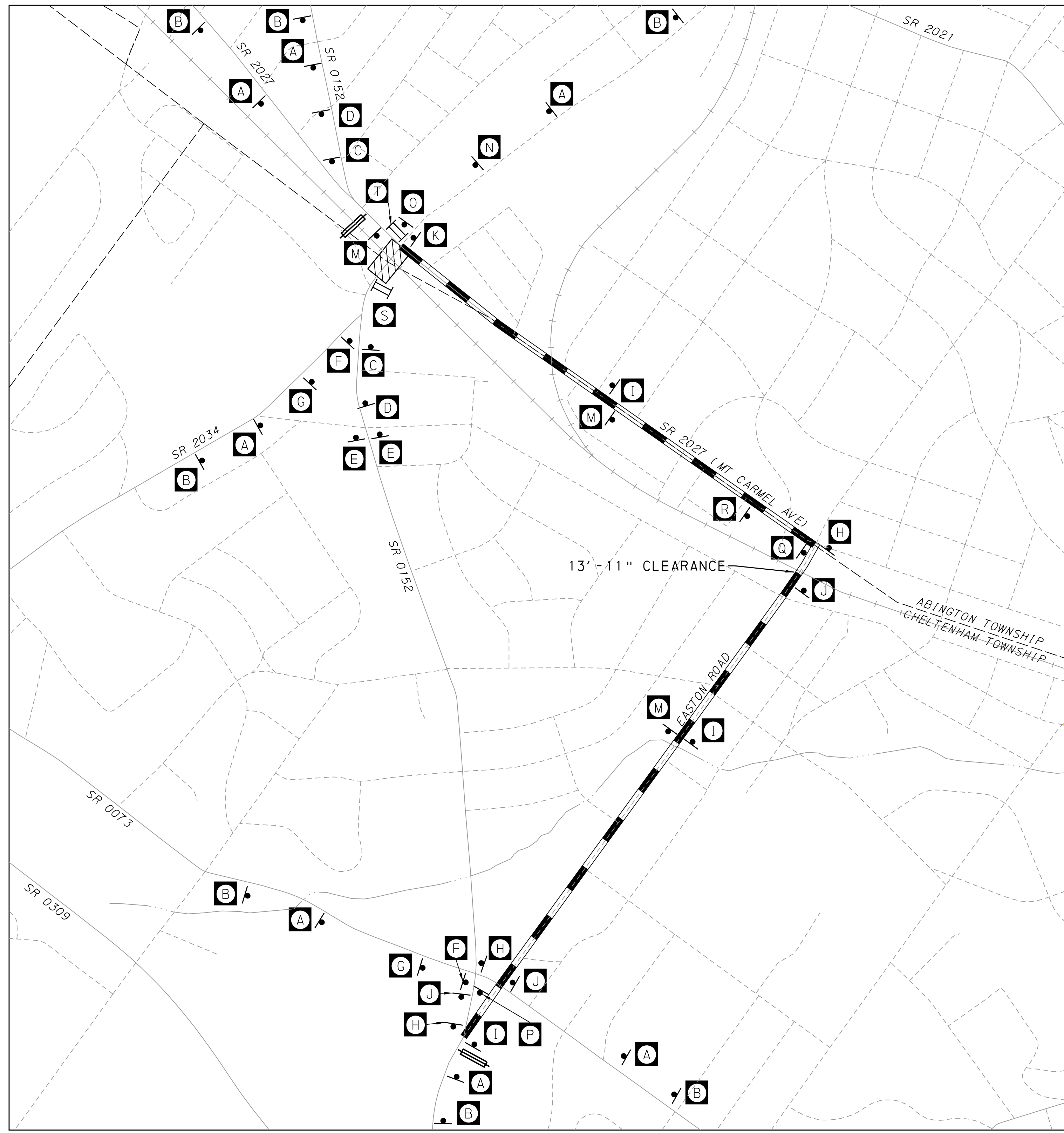

NOT TO SCALE

LEGEND

DETOUR ROUTE		WORK AREA	
STATE ROUTE		SIGN	
OTHER ROAD		TYPE III BARRICADE WITH SIGN	
RAILROAD		TYPE B FLASHING LIGHT (YELLOW)	
MUNICIPAL BOUNDARY		PORTABLE CHANGEABLE MESSAGE SIGN	
STREAM			

NOTES

- OVERALL DETOUR LENGTH = 1.5 MILES
- INSTALL TYPE B YELLOW FLASHING LIGHTS ON TOP OF TYPE III BARRICADES AND WARNING SIGNS AS SHOWN.
- SEE STAGE 1 AND STAGE 2 PLANS FOR ADDITIONAL TRAFFIC CONTROL.
- PROVIDE FLAGGER AT INTERSECTION OF EASTON RD AND MT CARMEL AVE AT ALL TIMES TO DIRECT TRUCK TRAFFIC COMPLETING RIGHT TURN MOVEMENTS.
- UTILIZE PORTABLE CHANGEABLE MESSAGE SIGNS TO INDICATE OVERNIGHT DETOUR AS DIRECTED BY THE REPRESENTATIVE.
- ALL SIGN ASSEMBLIES GREATER THAN NINE (9) SQUARE FEET MUST BE MOUNTED ON TYPE 3 BARRICADES OR GROUND MOUNTED TYPE B POSTS. REFER TO TC-8717, NOTE 2.

SR 0152 DETOUR

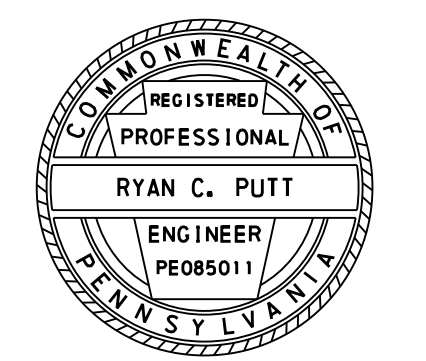

10/2/2019 6:21:50Z S-TR-DTRO1